



**Wednesday,
September 8, 2010
4:00-8:00 PM**

Bus departs **sharply at 4:00 PM**
from **Stearns County
Mississippi River County Park**,
located 7 miles north of Sartell on
County Road 1.
(map on reverse side)

Cost : Free
light dinner provided

**Registration is required
by September 1st**

Contact:

Kimberly Thielen Cremers

kimberly.tcremers@mn.nacdn.net

Phone: 320-251-7800 ext 161

Space is limited so register early!



**An invitation for local elected and appointed officials &
community leaders**

Land Use Impacts in the Shoreland Zone -a continuation of the Mississippi River Renaissance (MRR) Project

This fall workshop features an interactive bus tour that focuses on land use impacts in the shoreland of the River corridor. Participants from the spring workshop specifically identified high interest in more education about shoreland property practices, land use impacts and challenges, and stewardship and management decision options.

Objectives of this workshop are:

- **Build** an increased understanding of concepts of “shoreline”, the “shoreland zone”, and the “river corridor” and the regulations that units of government use to manage these.
- **Observe** the problems and challenges of multiple land uses in the shoreland and in the corridor.
- **Equip** your community’s “toolbox” with practices and policies you may want to consider.
- **Discuss** goals your community and the collective communities in the Renaissance Project region could identify and work on together.

Sponsored by:

Stearns County Soil & Water Conservation District's Mississippi River Renaissance Project

In partnership with:

University of Minnesota Extension-NEMO Program
Nonpoint Education for Municipal Officials and
MN Department of Natural Resources-Community Assistance Program

Map to Stearns County Mississippi River Park

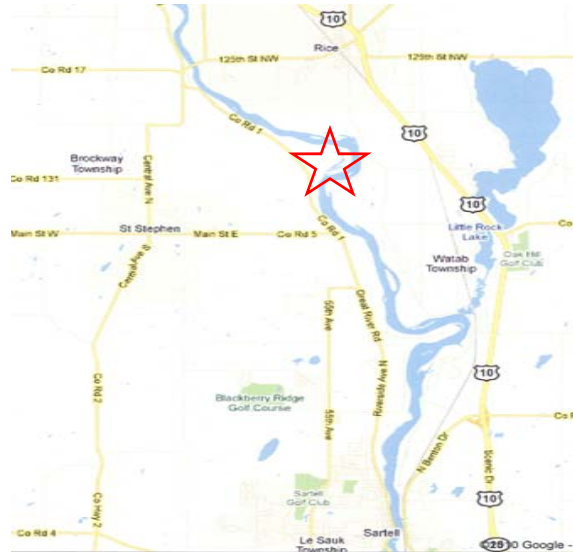

Meet in the Pavilion Parking lot at Stearns County Mississippi River Park– Park is located 7 miles north of Sartell on County Road 1 –look for the bus.

Bus departs
sharply at 4:00 PM!

About Mississippi River Renaissance (MRR)

The goal of the Mississippi River Renaissance Project is to unite communities in the urban, suburban, and rural stretches of the Mississippi River in Stearns and Benton Counties by bringing resources and information to the people whose decisions and actions that can help keep the river healthy. By creating a forum of communication sharing among river community decision makers, we can be a landmark that “unites” and places the Mississippi River at the center of our decisions.

About NEMO

NEMO or *Nonpoint Education for Municipal Officials* is an education and training program that builds the knowledge and skills of local decision makers, elected & appointed officials, and community leaders in the area of water and natural resource management. NEMO Programs provide resources that hopefully lead to more informed land use decisions for the community.

Workshop Contacts:

Kimberly Thielen Cremers

Stearns County Soil & Water Conservation District

Central MN Mississippi River Renaissance Coordinator

Phone: (320) 251-7800 x 161

Email: kimberly.tcremers@mn.nacdnet.net

John Bilotta

University of Minnesota

Extension Educator -Water Resource Management & Policy

Phone: (651) 480-7708

Email: jbilotta@umn.edu

Mark Hauck

MN Dept. of Natural Resources-Community Assistance Specialist

Phone: (320) 255-4279 x 236

Email: mark.hauck@state.mn.us

